

CATEGORY	DESCRIPTION	P/N #
CONNECTOR	RCA+Toslink, 2*1 Ports, R/A, T/H, With Shielding, Top Screw Hole*1	RT002R-21170-030T

PART NO.:
RT002R-21170-030T
表示光纖高壓射

REV.	ECN NO	DESCRIPTION	REVISED	DATE
R01		New Release	XY	2009.09.18

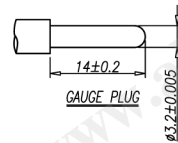
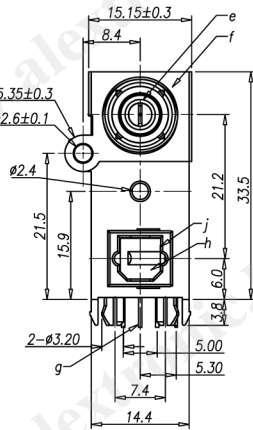
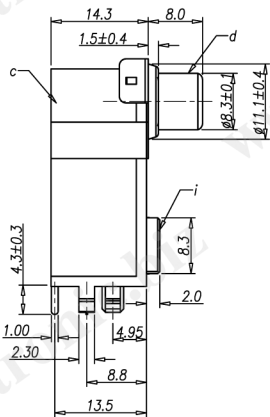
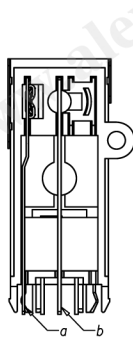

SPECIFICATION

1. Voltage and Current Rating: 12V & 1A
2. Contact resistance: 30mΩ MAX.
3. Insulation resistance: 100MΩ MIN. @ DC500V
4. Withstand voltage: 500VAC for 1min
5. Insertion Force: 3Kgf MAX.
6. Extraction Force: 0.3Kgf MIN.
7. Withdraw Force for Center Contact: 0.08Kgf MIN.
8. Terminal Strength: The terminal shall be capable of withstanding a force of 3Kgf applied in any direction for 0.5 secs without lossing and breakdown
9. Life test: 1,500 cycles
10. Temperature Range: -25°C~70°C
11. To conform with the "QC-03-045" & "RoHS DIRECTIVE"
12. Solder heat resistance: wave soldering 260°C 5 secs

SPECIFICATION

1. Voltage Rating: Vcc=0.5~7V, Vin=-0.5~7.5V
2. Current Rating: 20mA
3. Insulation resistance: 100MΩ MIN.
4. Insertion Force: 2.5Kgf MAX.
5. Extraction Force: 0.5Kgf MIN.
6. Life test: 1,500 cycles
7. Temperature Range: -20°C~70°C

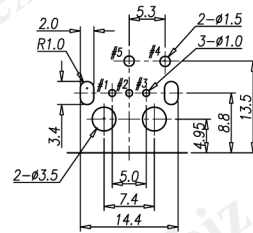
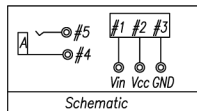
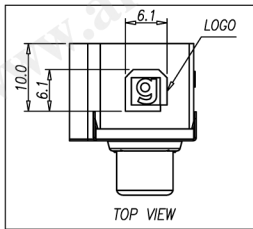

Recommend PCB Layout(Jack Top View)
Tolerance: ±0.05mm
Recommend PCB Thickness: 1.6mm

j	Spring	1	SUS		
i	Frame	1	PA66 UL94V-0	Black	
h	Gate	1	PA66 UL94V-2	Black	
g	ODL	1	16Mbps		
f	Shielding	1	Brass, T=0.25mm	Tin Plating	
e	Washer	1	PBT UL94V-0	Orange	
d	Outer Contact	1	Brass, T=0.40mm	Tin Plating	
c	Housing	1	PBT UL94V-0	Black	
b	Terminal #5	1	Brass, T=0.50mm	Tin Plating	
a	Terminal #4	1	Brass, T=0.40mm	Tin Plating	
NO.	PART NAME	Q'TY	MATERIAL	PLATING & COLOR	Remark

UNLESS OTHERWISE SPECIFIED TOLERANCES		SCALE: 1/1	UNIT: mm	DWG. NO:
DECIMALS: X.X ±0.5, X.XX ±0.3, X.XXX ±0.2		SIZE: A3		W-061-700
ANGLES: X ±2°, X.X ±1°		PAGE: 1 OF 1		REV: R01
APPROVED BY: WYX		CHECKED BY: Pengjie		PREPARED BY: XSY
CUSTOMER COPY				